

**RESOLUTION NO. SCV-259**

**JOINT RESOLUTION OF  
THE BOARD OF SUPERVISORS OF THE COUNTY OF LOS ANGELES,  
THE BOARD OF TRUSTEES OF THE GREATER LOS ANGELES COUNTY VECTOR  
CONTROL DISTRICT, THE BOARD OF DIRECTORS OF THE SANTA CLARITA  
VALLEY WATER AGENCY APPROVING AND ACCEPTING THE  
NEGOTIATED EXCHANGE OF PROPERTY TAX REVENUES  
RESULTING FROM ANNEXATION OF TRACT 60259  
TO COUNTY LIGHTING MAINTENANCE DISTRICT 1687**

WHEREAS, pursuant to Section 99.01 of the California Revenue and Taxation Code, prior to the effective date of any jurisdictional change that will result in a special district providing one or more services to an area where those services have not previously been provided by any local agency, the special district and each local agency that receives an apportionment of property tax revenue from the area must negotiate an exchange of property tax increment generated in the area subject to the jurisdictional change and attributable to those local agencies; and

WHEREAS, the Board of Supervisors of the County of Los Angeles, acting on behalf of the County Lighting Maintenance District (CLMD) 1687, Los Angeles County General Fund, Los Angeles County Public Library, Los Angeles County Road Maintenance District 5, the Consolidated Fire Protection District of Los Angeles County, Los Angeles County Flood Control Drainage Improvement Maintenance District, and Los Angeles County Flood Control District; the Board of Trustees of the Greater Los Angeles County Vector Control District; and the Board of Directors of the Santa Clarita Valley Water Agency (CLWA, NCW, NCE02S, and NCW02W) have determined that the amount of property tax revenue to be exchanged between their respective agencies as a result of the annexation proposal identified as Tract 60259 to CLMD 1687 is as shown on the attached Property Tax Transfer Resolution Worksheet.

//  
//  
//  
//  
//  
//  
//  
//  
//  
//  
//  
//  
//  
//  
//

NOW, THEREFORE, BE IT RESOLVED AS FOLLOWS:

1. The negotiated exchange of property tax revenues between CLMD 1687, Los Angeles County General Fund, Los Angeles County Public Library, Los Angeles County Road District 5, the Consolidated Fire Protection District of Los Angeles County, Los Angeles County Flood Control Drainage Improvement Maintenance District, Los Angeles County Flood Control District, the Greater Los Angeles County Vector Control District, and the Santa Clarita Valley Water Agency (CLWA, NCW, NCE02S, and NCW02W) resulting from the annexation of Tract 60259 to County Lighting Maintenance District 1687 is approved and accepted.

2. For fiscal years commencing on or after July 1, 2022, or the July 1 after the effective date of this jurisdictional change, whichever is later, the property tax revenue increment generated from the area within Tract 60259, Tax Rate Areas 09142 shall be allocated to the affected agencies as indicated on the Property Tax Transfer Resolution Worksheet.

3. No transfer of property tax revenues other than those specified in Paragraph 2 shall be made as a result of the annexation of Tract 60259.

4. If at any time after the effective date of this resolution, the calculations used herein to determine initial property tax transfers or the data used to perform those calculations are found to be incorrect, thus, producing an improper or inaccurate property tax transfer, the property tax transfer shall be recalculated and the corrected transfer shall be implemented for the next fiscal year

PASSED, APPROVED, AND ADOPTED this 1st day of March 2022, by the following vote:

Directors Armitage, Atkins, Braunstein, Colley, Cooper, Ford, Gladbach, Kelly,  
AYES: Martin, Mortensen, Orzechowski and Plambeck  
NOES: None.  
ABSENT: None.  
ABSTAIN: None.

SANTA CLARITA VALLEY WATER  
AGENCY- NCW

By *Bayl Martin*  
President, Board of Directors

ATTEST:

*April Jacobs*  
Secretary

March 1, 2022  
Date



ANNEXATION TO: CO LIGHTING MAINT DIST NO 1687  
 ACCOUNT NUMBER: 019.40  
 TRA: 09142  
 EFFECTIVE DATE: 07/01/2021  
 ANNEXATION NUMBER: TR 60259 PROJECT NAME: TRACT 60259

DISTRICT SHARE: 0.021387834

ACCOUNT #	TAXING AGENCY	CURRENT TAX SHARE	PERCENT	PROPOSED DIST SHARE	ALLOCATED SHARE	ADJUSTMENTS	NET SHARE
001.05	LOS ANGELES COUNTY GENERAL	0.181560218	18.1574 %	0.021387834	0.003883191	-0.003974945	0.177585273
001.20	L.A. COUNTY ACCUM CAP OUTLAY	0.000117520	0.0117 %	0.021387834	0.000002513	0.000000000	0.000117520
003.01	L A COUNTY LIBRARY	0.025304385	2.5304 %	0.021387834	0.000541205	-0.000541205	0.024763180
005.25	ROAD DIST # 5	0.006707708	0.6707 %	0.021387834	0.000143463	-0.000143463	0.006564245
007.30	CONSOL. FIRE PRO.DIST.OF L.A.CO.	0.185810671	18.5810 %	0.021387834	0.003974087	-0.003974087	0.181836584
007.31	L A C FIRE-FFW	0.004172531	0.4172 %	0.021387834	0.000089241	0.000000000	0.004172531
030.10	L.A.CO.FL.CON.DR.IMP.DIST.MAINT.	0.001908680	0.1908 %	0.021387834	0.000040822	-0.000040822	0.001867858
030.70	LA CO FLOOD CONTROL MAINT	0.010823529	1.0823 %	0.021387834	0.000231491	-0.000231491	0.010592038
061.80	GREATER L A CO VECTOR CONTROL	0.000322714	0.0322 %	0.021387834	0.000006902	-0.000006902	0.000315812
068.05	ANTELOPE VY RESOURCE CONSER DIST	0.000000000	0.0000 %	0.021387834	0.000000000	0.000000000	0.000000000
302.01	SANTA CLARITA VALLEY WATER-CLWA	0.061038339	6.1038 %	0.021387834	0.001305477	-0.001305477	0.059732862
309.01	SANTA CLARITA VALLEY WATER-NCW	0.001295737	0.1295 %	0.021387834	0.000027713	-0.000027713	0.001268024
309.02	STA CLRTA VALLEY WTR-NCW02S	0.024497968	2.4497 %	0.021387834	0.000523958	-0.000523958	0.023974010
309.03	STA CLRTA VALLEY WTR-NCW02W	0.021533616	2.1533 %	0.021387834	0.000460557	-0.000460557	0.021073059
400.00	EDUCATIONAL REV AUGMENTATION FD	0.066692841	6.6692 %	0.021387834	0.001426415	EXEMPT	0.066692841
400.01	EDUCATIONAL AUG FD IMPOUND	0.131877650	13.1877 %	0.021387834	0.002820577	EXEMPT	0.131877650
400.15	COUNTY SCHOOL SERVICES	0.001509686	0.1509 %	0.021387834	0.000032288	EXEMPT	0.001509686
400.21	CHILDREN'S INSTIL TUITION FUND	0.002992253	0.2992 %	0.021387834	0.000063997	EXEMPT	0.002992253
665.01	SULPHUR SPRINGS UNION SCHOOL DIS	0.091792549	9.1792 %	0.021387834	0.001963243	EXEMPT	0.091792549

ANNEXATION NUMBER: TR 60259

PROJECT NAME: TRACT 60259

TRA: 09142

ACCOUNT #	TAXING AGENCY	CURRENT TAX SHARE	PERCENT	PROPOSED DIST SHARE	ALLOCATED SHARE	ADJUSTMENTS	NET SHARE
665.06	CO.SCH.SERV.FD.- SULPHUR SPRINGS	0.007873873	0.7873 %	0.021387834	0.000168405	EXEMPT	0.007873873
665.07	DEV.CTR.HDCPD-MINOR-SULPHUR SPGS	0.000867844	0.0867 %	0.021387834	0.000018561	EXEMPT	0.000867844
757.02	HART WILLIAM S UNION HIGH	0.086097325	8.6097 %	0.021387834	0.001841435	EXEMPT	0.086097325
757.06	CO.SCH.SERV.FD.- HART,WILLIAM S.	0.000361602	0.0361 %	0.021387834	0.000007733	EXEMPT	0.000361602
757.07	HART,WILLIAM S.-ELEM SCHOOL FUND	0.045299632	4.5299 %	0.021387834	0.000968861	EXEMPT	0.045299632
814.04	SANTA CLARITA COMMUNITY COLLEGE	0.039541129	3.9541 %	0.021387834	0.000845699	EXEMPT	0.039541129
***019.40	CO LIGHTING MAINT DIST NO 1687	0.000000000	0.0000 %	0.021387834	0.000000000	0.000000000	0.011230620
TOTAL:		1.000000000	100.0000 %		0.021387834	-0.011230620	1.000000000

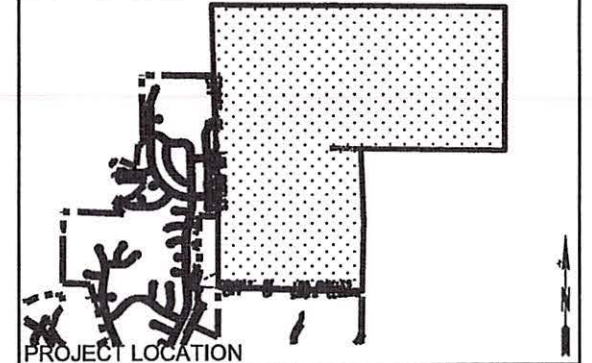
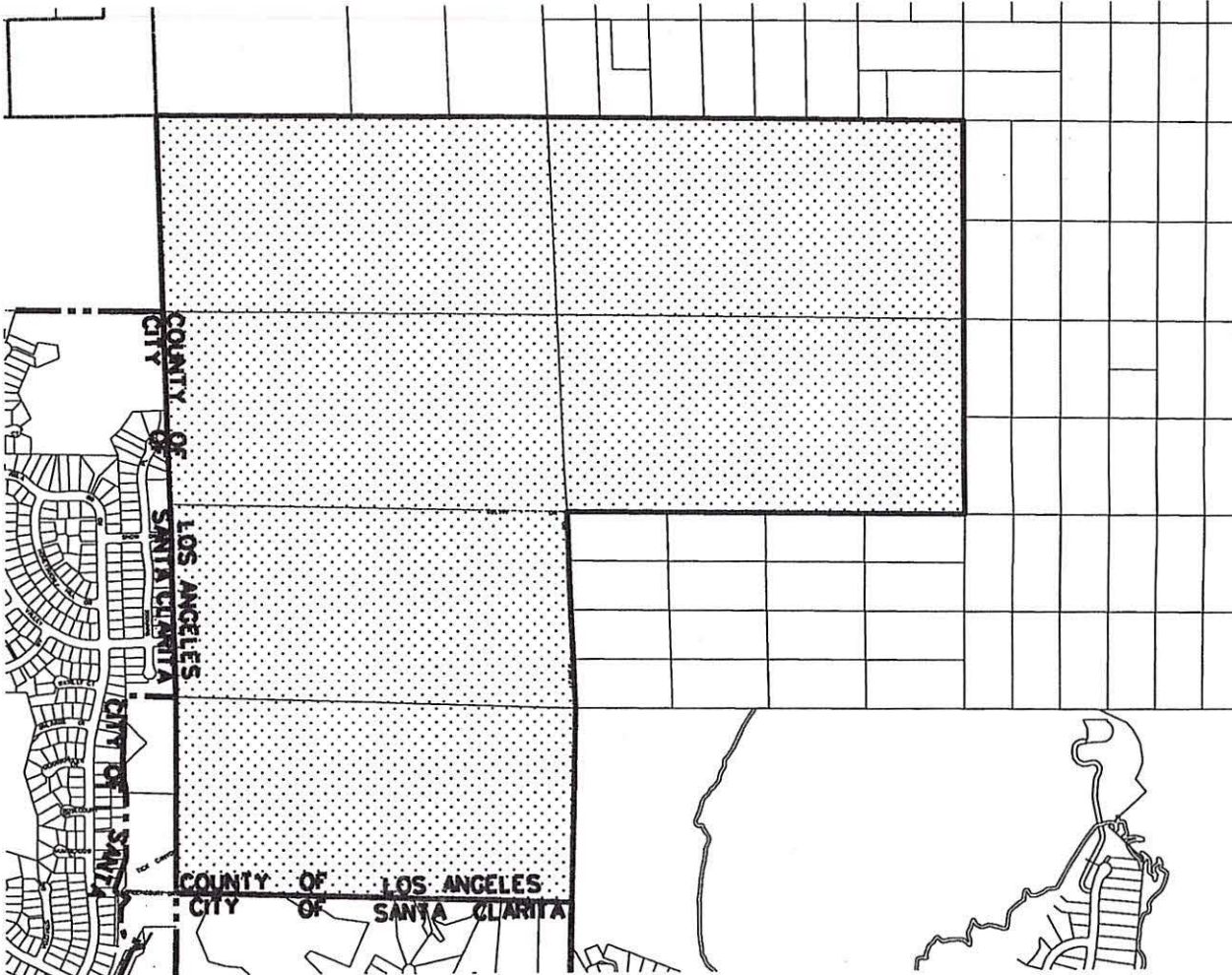

TRACT 60259



PROJECT LOCATION  
VICINITY MAP T.G. page 4462-H3 to H5, J3, & J4

<b>TRA'S</b>
9125
9142
10683
<b>APN'S</b>
2853-006-005
2853-007-002
2853-007-003
2854-003-006
3211-018-058
3211-019-017

**LEGEND**

-  PROPOSED ANNEXATION AREA
-  CITY/COUNTY BOUNDARY

PROPOSED ANNEXATION TO COUNTY LIGHTING  
MAINTENANCE DISTRICT 1687 AND COUNTY  
LIGHTING DISTRICT LLA-1 (UNINCORPORATED ZONE)

LOS ANGELES COUNTY PUBLIC WORKS  
TRAFFIC SAFETY AND MOBILITY DIVISION  
STREET LIGHTING SECTION

**CLMD 1687  
CANYON COUNTRY AREA**

Prepared By	TD	Sheet	1 of 1	Date	
Recommended By	<i>Figueroa</i>			Date	11/01/2021
Approved By	<i>Jorge Herrera</i>			Date	11/11/2021

TR 60259